



Picture shown may not represent actual package

C9 SOUND ATTENUATED & WEATHER PROTECTIVE ENCLOSURES

US Sourced

180 – 300 kW 60 Hz

Features

ROBUST / HIGHLY CORROSION RESISTANT CONSTRUCTION

- Factory installed on skid base
- Environmentally friendly, polyester powder baked paint
- 14 gauge steel
- Zinc plated or stainless steel fasteners
- Internally mounted critical exhaust silencing system (Sound attenuated only)
- Externally front mounted enclosed exhaust silencing system (weather protective only)
- Designed and tested to comply with UL 2200 Listed generator set package
- Compression door latches providing solid door seal

EXCELLENT ACCESS

- Large cable entry area for installation ease
- Accommodates side mounted single or multiple breakers
- Two doors on both sides
- Vertically hinged allow 180° opening rotation and retention with door stays.
- Lube oil and coolant drains routed to the exterior of the enclosure base

TRANSPORTABILITY

These enclosures are of extremely rugged construction to withstand outdoor exposure and rough handling common on many construction sites.

SECURITY AND SAFETY

- Lockable access doors which give full access to control panel and breaker
- Cooling fan and battery charging alternator fully guarded
- Fuel fill, oil fill, and battery can only be reached via lockable access
- Externally mounted emergency stop button
- Designed for spreader bar lifting to ensure safety
- Stub-up area is rodent proof

OPTIONS

- Caterpillar yellow or white paint
- Weather protective
- Sound attenuated Level 1
- Sound attenuated Level 2
- UL Listed 203 gallon integral fuel tank
- UL Listed 660 or 1002 gallon sub base fuel tanks
- Seismic certification per applicable building codes: IBC 2000, IBC 2003, IBC 2006, IBC 2009, IBC 2012, CBC 2007, CBC 2010
- IBC Certification for 150 mph wind loading
- Anchoring details are site specific and are dependent on many factors such as generator set size, weight, and concrete strength. IBC Certification requires that the anchoring system used is reviewed and approved by a professional engineer.
- Control panel viewing window*

*(Sound Attenuated Only)

Enclosure Sound Levels at Standby Ratings

Enclosure Type	Standby ekW	Cooling Air Flow Rate		Ambient Capability*		Sound Pressure Levels (dBA) at					
						1m (3.3 ft)		7m (23 ft)		15m (49 ft)	
		m ³ /min	cfm	°C	°F	100% Load	75% Load	100% Load	75% Load	100% Load	75% Load
Sound Attenuated Level 2	300	351	12395	46	115	83.0	82.8	71.3	71.2	65.3	65.2
	250	351	12395	53	127	82.8	82.7	71.2	71.2	65.2	65.2
	200	351	12395	59	138	82.7	82.7	71.2	71.1	65.2	65.1
Weather Protective	300	516	18222	49	120	93.1	93.0	82.4	82.1	76.4	76.1
	250	516	18222	55	131	93.0	92.9	82.2	82.0	76.2	76.0
	200	516	18222	60	140	92.9	92.8	82.0	82.0	76.0	76.0

*Cooling system performance at sea level. Consult your Cat® dealer for site specific ambient and altitude capabilities.

Note: Sound Attenuated Level 1 enclosure is designed for 75 dBA @7m at 100% Standby load.

Enclosure Sound Levels at Prime Ratings

Enclosure Type	Prime ekW	Cooling Air Flow Rate		Ambient Capability*		Sound Pressure Levels (dBA) at					
						1m (3.3 ft)		7m (23 ft)		15m (49 ft)	
		m ³ /min	cfm	°C	°F	100% Load	75% Load	100% Load	75% Load	100% Load	75% Load
Sound Attenuated Level 2	275	351	12395	50	122	82.9	82.8	71.3	71.2	65.3	65.2
	225	351	12395	56	133	82.8	82.7	71.2	71.1	65.2	65.1
	180	351	12395	60	140	82.7	82.7	71.1	71.0	65.1	65.0
Weather Protective	275	516	18222	52	126	93.1	92.9	82.3	82.1	76.3	76.1
	225	516	18222	59	138	93.0	92.8	82.1	82.0	76.1	76.0
	180	516	18222	60	140	92.9	92.7	82.0	82.0	76.0	76.0

*Cooling system performance at sea level. Consult your Cat dealer for site specific ambient and altitude capabilities.

Note: Sound Attenuated Level 1 enclosure is designed for 75 dBA @7m at 100% Prime load.

The sound pressure level data shown in the tables above is quoted as free field and is for guidance only. Actual levels produced may vary according to site conditions.

Enclosure Weights and Dimensions

Enclosure on Skid Base

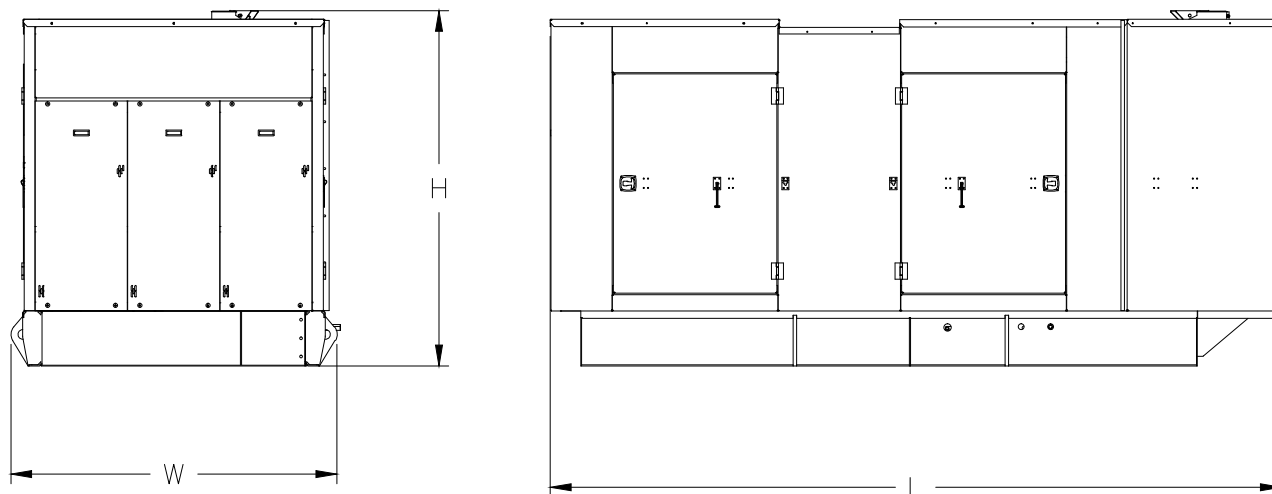

Enclosure Type	Length "L"		Width "W"		Height "H"		Weight	
	mm	in	mm	in	mm	in	kg	lb
Sound Attenuated	4515	177.8	2037	80.2	2196	86.5	3407	7511
Weather Protective	4035	158.9	2037	80.2	2142	84.3	3124	6887

Enclosure on a UL Listed 203 Gallon Integral Fuel Tank Base

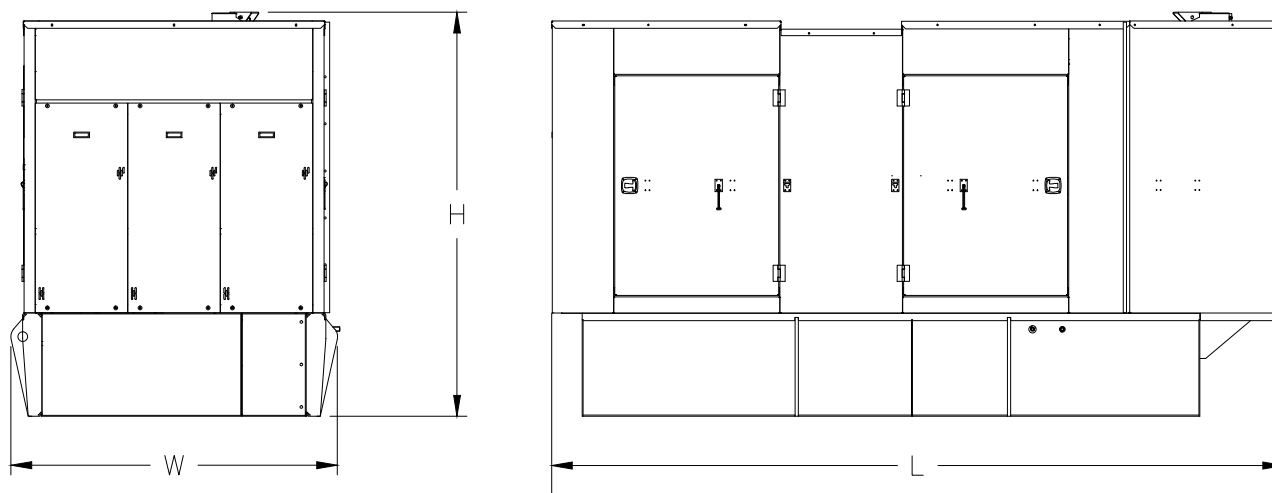

Enclosure Type	Length "L"		Width "W"		Height "H"		Weight	
	mm	in	mm	in	mm	in	kg	lb
Sound Attenuated	4515	177.8	2014	79.3	2492	98.1	3883	8561
Weather Protective	4035	158.9	2014	79.3	2438	96.0	3620	7981

Enclosure on a UL Listed 660 Gallon Sub Base Fuel Tank Base

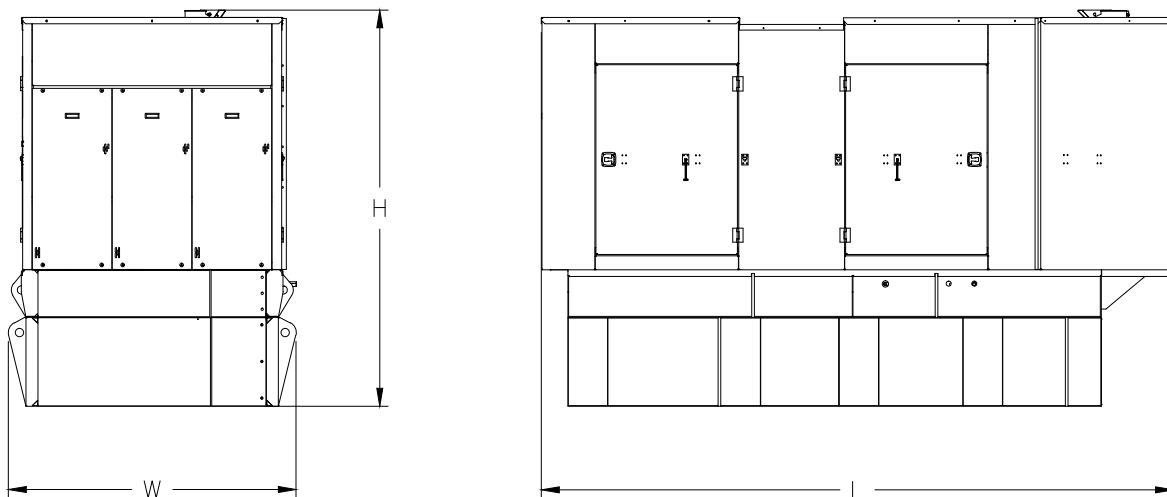

Enclosure Type	Length "L"		Width "W"		Height "H"		Weight	
	mm	in	mm	in	mm	in	kg	lb
Sound Attenuated	4515	177.8	2056	80.9	2831	111.5	4875	10748
Weather Protective	4035	158.9	2056	80.9	2777	109.3	4592	10124

Enclosure on a UL Listed 1002 Gallon Sub Base Fuel Tank Base

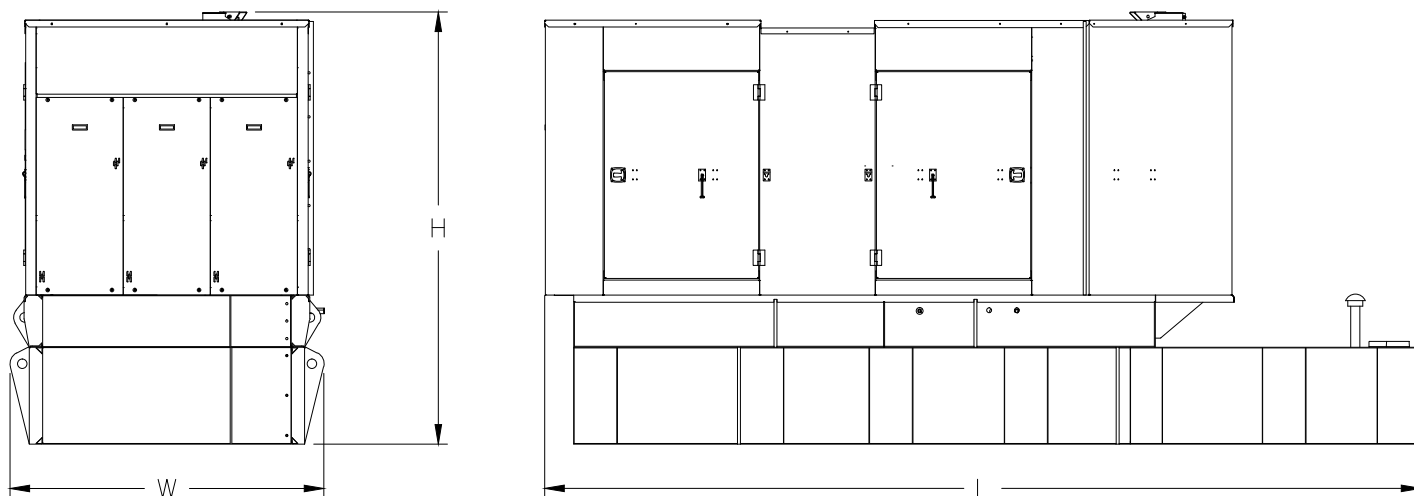

Enclosure Type	Length "L"		Width "W"		Height "H"		Weight	
	mm	in	mm	in	mm	in	kg	lb
Sound Attenuated	5739	225.9	2056	80.9	2831	111.5	5267	11612
Weather Protective	5739	225.9	2056	80.9	2777	109.3	4984	10988

Information contained in this publication may be considered confidential.
Discretion is recommended when distributing.

Materials and specifications are subject to change without notice.
CAT, CATERPILLAR, their respective logos, "Caterpillar Yellow," the "Power Edge" trade dress, as well as corporate and product identity used herein, are trademarks of Caterpillar and may not be used without permission.

www.Cat-ElectricPower.com

© 2014 Caterpillar
All Rights Reserved.
Printed in U.S.A.